

State of South Carolina

2109

Pursuant to a warrant from John Thomas Esq. Commissioner of Locations in the 1st district No. Saluda dated 29th Nov. 1784 I have admeasured and laid out unto John Haines about of Land containing Two hundred acres on a branch of the Saluda River, bounding N.W. by Eleanor M. Whorters land and on the S. by vacant land and hath such shape and marks as the annexed Plot Represents,

Survey 9th Nov. 1784 Ber. Glenn D. and Recorded 22nd Nov. 1784

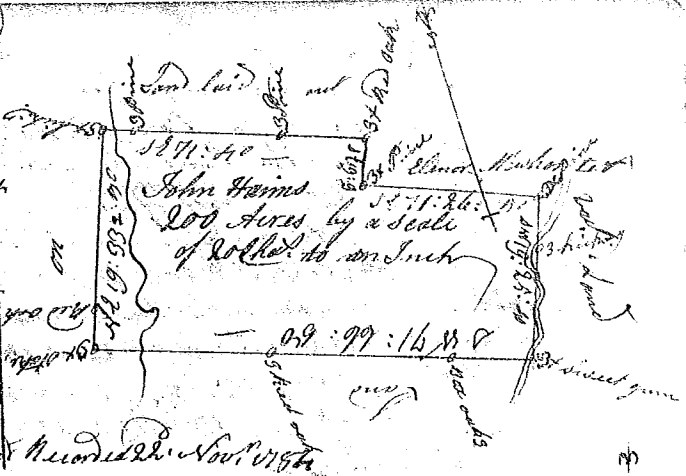

State of South Carolina

Pursuant to a warrant from John Thomas Esq. Commissioner of Locations in the 1st district No. Saluda River dated 20 Oct. 1784, I have admeasured and laid out unto Charles Hains about of Land containing Two hundred acres in the 1st district No. of Saluda River on Little Sandy Run a branch of the Saluda River bounding S.W. by John Foster and Vacant land, N.E. by Benj. Coopers, on all other sides on Vacant land, and hath shape and marks as the annexed Plot Represents, Survey 9th Nov. 1784 Recorded 22nd Nov. 1784 Ber. Glenn D.

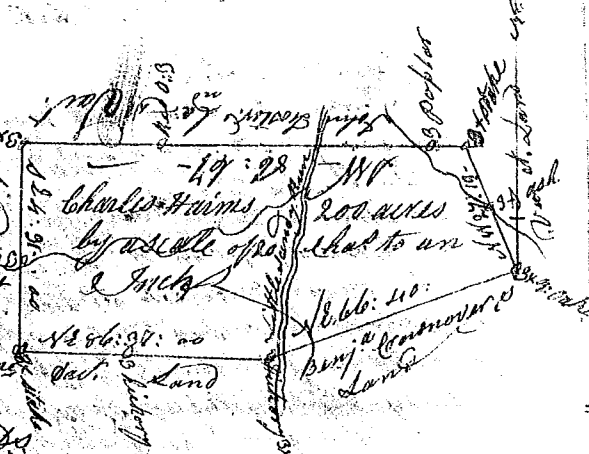

State of South Carolina

Pursuant to a warrant from John Thomas Esq. Commissioner of Locations dated 11 Sept. 1784 I have admeasured and laid out unto Samuel Henderson a tract of 510 acres of Land situate in Ninety six district below the ancient boundary line on the branches of Immouse Creek to the S.W. of Saluda a branch of Little River bounded S. and S.E. on Samuel Cabins and lands laid out by David Henderson's land and on the N. by Young's land and hath such shape and marks as the above Plot Represents, Survey 22nd Sept. 1784 Ber. Glenn D.

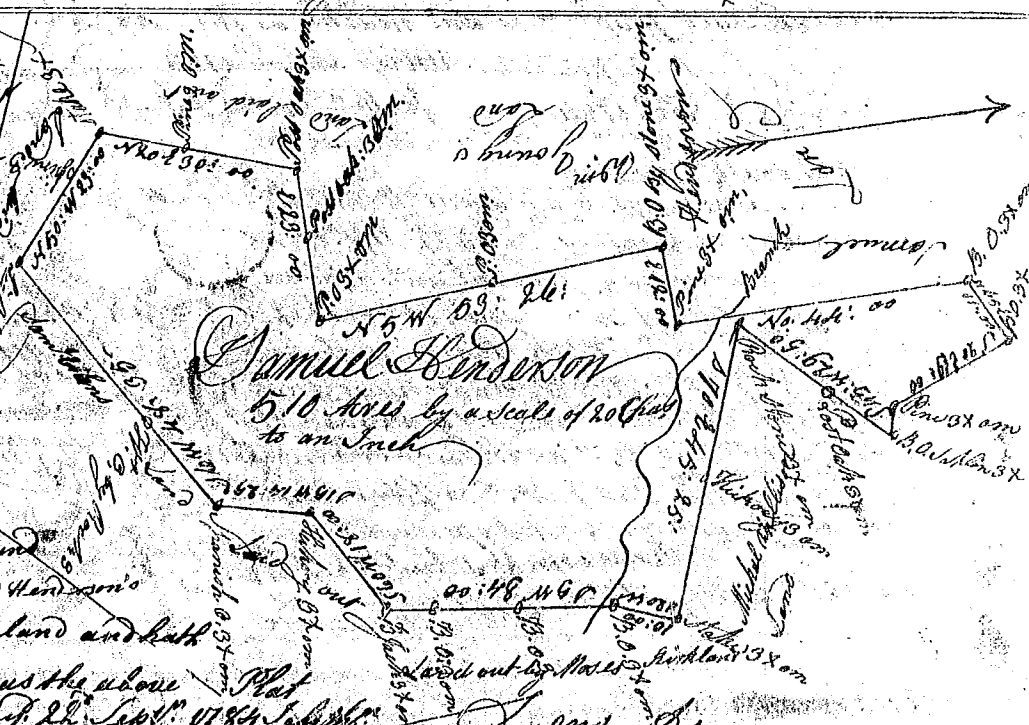

State of S. Carolina... Pursuant to a warrant from John Thomas Esq. Commissioner of Locations dated the 20th Feb. 1784 I have admeasured and laid out unto Robert Simson a tract of one hundred and sixty acres of Land, situate in Ninety six district on the waters of Little River below the line bounded N. E. on Wm. Simson N. W. on Sam. Whiners and all other sides Vacant, and hath such shape and marks as the annexed Plot Represents, Survey 22nd Feb. 1784 Recorded the 22nd Nov. 1784

